

Daylight Fresnel 2500W SE



■ SPECIFICATIONS

Identity No.	L02500DS
Capacity	2,500W
Lamp Bulb Voltage	115V
Fresnel Lens	Ø250mm (9-7/8 in.)
Lamp Type	MSR 2500HR or HMI 2500W/SE
Color Temp.	5600K
Lamp Holder	G38
Stirrup	Ø28mm (1-1/8 in.) Spigot
Class / IP Rating	1 / IP 23
Max. Surface Temp.	160 °C
Max. Ambient Temp.	45 °C
Min. Distance to Illuminated Object	8 m
Min. Distance to Flammable Object	1 m
Operating Range	+45° ~ 0° ~ -45°
Weight (lamphead)	17.1 kg
Weight (with barndoor)	18.8 kg

■ DIMENSIONS (mm)

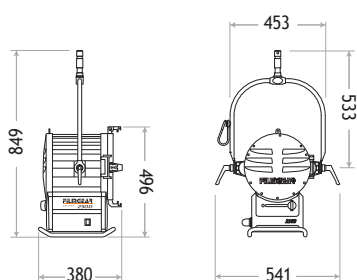

■ PHOTOMETRIC DATA

2500W			
Spot (7°)			
Lux	106366	26591	11818
Beam Ø	0.49 m	0.98 m	1.47 m
Flood (60°)			
Lux	8099	2025	900
Beam Ø	4.62 m	9.24 m	13.86 m

■ LAMPHEAD CONTENTS

Lamp Housing without Bulb (purple grey & silver color)

4-leaf Rotatable Barndoor with Safety Wire

Ø250mm (10 in.) Fresnel Lens

Power Cable with Multi-Pin Connector

Stirrup with Ø28mm (1-1/8 in.) Spigot

Requires Electronic Ballast, Lamphead to Ballast Cable and Lamp Bulb

■ ACCESSORIES

Electronic Ballast V3 : 4kW/2.5kW or 2500W

Lamphead to Ballast Cable : 7m (23 ft.) or 15m (49 ft.)

4-leaf Rotatable Barndoor

Set of 4 Scrims Ø330mm (13 in.) : Full Single, Full Double, Half Single, Half Double

Scrim Bag

Safety Cable (for lamphead)

Safety Wire (for barndoor)